

OVERCOME CHALLENGES - ENHANCE BRAND LEVELS

Established in 2003, Sagen is known as the leading brand in Vietnam in the field of designing pharmaceutical and food factories according to high-tech standards GMP-WHO, EU, FDA, PIC/s, HACCP... In recent years, Sagen has made a change in development orientation, not only in the industrial factory market, Sagen has rapidly developed into the design market of apartments, residential areas, offices, and guests. hotels, resorts, international schools...

In 2020, The whole world was in crisis before the Covid 19 pandemic suddenly arrived and quickly spread, causing heavy damage all socio-economic activities of the World and Vietnam.

Accordingly, investment activities, construction of factories, warehouses, workshops as well as real estate investment projects decreased sharply, causing the construction industry in general and the design consulting industry in particular to face challenges. big wake. With the determination to overcome difficulties, 2020 has become Sagen's pride when surpassing major competitors, becoming a reliable partner to sign contracts to implement a series of large projects such as Ho Tram Complex. Complex with more than 7.5 hectares in Ba Ria - Vung Tau (Hung Thinh), Saigon Silicon City (SSC) 52 hectares in High Industrial Park in District 9, Aqua City - Bien Hoa Trade Center over 30,000 m² (Novaland), School FPT University in Binh Dinh and Can Tho (FPT Education), Nam A Bank Can Tho office building (Hoan Cau Group) ... In which, the Ho Tram Complex project is expected to become an ideal place to live and relax. New project in Ba Ria - Vung Tau with a scale of 22-storey apartment complex with GFA of more than 206,000 m², cluster of 3-storey commercial buildings (5 blocks) with GFA of more than 15,400 m², cluster of Primary schools



Ho Tram Complex – Source: Provided by the Investor
Address: Ba Ria - Vung Tau - Scalw 206,000 m²



FPT University in Binh Dinh
Address: Quy Nhon City, Binh Dinh Province - Scale: 30,000 m²



Center 3 and Central Square of Sai Gon Silicon City (SSC) 52.9 ha
Address High-Tech Park, Dist.9, HCMC - Scale: 60,000 m²

4 floors with GFA of more than 2,400 m², with many important utilities such as GYM, Spa, swimming pool, park,... Besides, the design implementation for Saigon Silicon City project - a high-tech park Following the Silicon Valley model, it is also Sagen's honor to participate in the implementation of a large project, which is of great significance in the economic development, science and technology of the country as well as promoting the cooperation relationship between the two countries. strategic cooperation between two big cities San Francisco and Ho Chi Minh City. Sagen continues to maintain its position in the industrial plant design market with the deployment of Mapletree Logistics Factory in Hung Yen, Medical Equipment Factory (Benovas), DHG Pharmaceutical Finished Product Warehouse (DHG). , Factory producing liquefied petroleum gas (Air Liquide),...

In addition, the Opal Skyline luxury apartment project was officially opened for sale and the Clubhouse project of Gem Skyworld Residential Area was inaugurated, which also resonated greatly in the real estate market in 2020 and contributed to affirming its capacity. of Sagen in implementing on schedule, ensuring the unique aesthetic and architectural highlights for each project. The success in the business field creates a favorable premise for Sagen to not only overcome the challenges of the Covid pandemic but also constantly expand and develop high-quality human resources with nearly 100 employees. Working, studying and dedicating at Sagen as well as bringing about the most impressive financial results during the past 5 years when sales reached nearly 100% of the plan and increased by over 30% compared to 2019. is an extremely proud result of the Board of Directors as well as all Sagen employees when working together to overcome many difficulties and events in 2020.

The year 2021 is approaching, Sagen will focus on strategic tasks: Improve capacity in all aspects to meet customer requirements and prepare to deploy BIM/REVIT synchronously in Q2/2020 to bring new innovations. the most optimal products, providing services that bring international standards to the domestic market as well as fulfilling the aspiration to elevate the Sagen brand to the international market.



Hung Yen Logistics Park I of Mapletree
Address: Viglacera Yen My - Hung Yen Industrial Park Scale 280,000 m²



Industrial Cluster's for manufacturing Medical Equipment
Address: Mong Cai - Quang Ninh Scale: 246,000 m²



Sagen

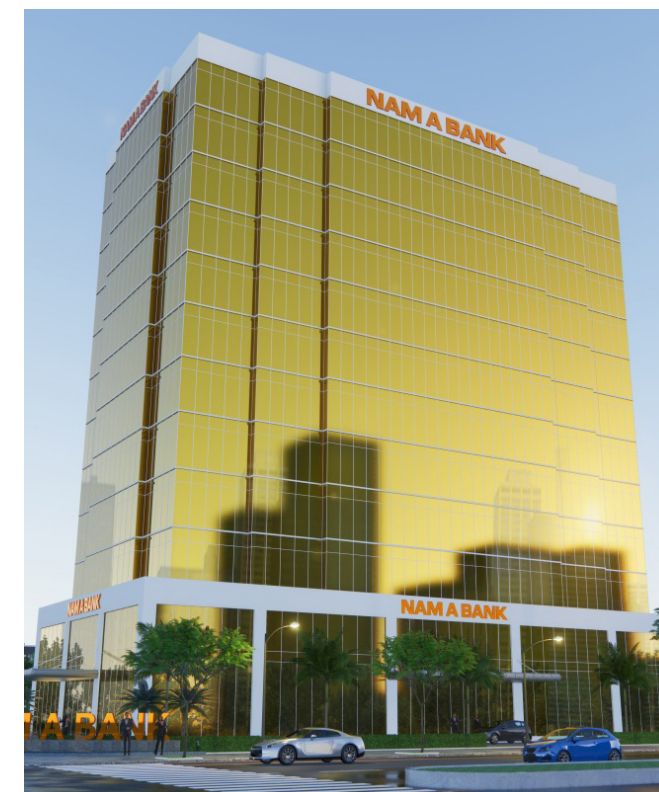

Nam A Bank Office Building
Address: Cai Rang, Can Tho - Scale 12,500m²



Ba Thien Executive Office
Address: Ba Thien Industrial Park, Vinh Phuc - Scale: 22,100 m²

CONTACT INFO:
Sagen Constructive Design Consultancy Joint Stock Company
Address: 38 Lam Son, Ward 06, Binh Thanh District, HCMC
Phone: 028. 3510 9900 - Hotline: 0906.605.099
Web: www.sagen.com.vn - Email: sagen@sagen.com.vn